



18	Asphalt Pavement Replacement, Surface	77	TON	\$150.00	\$11,550.00	94.61	\$14,191.50	\$2,641.50
19	Asphalt Pavement Replacement, Intermediate	56	TON	\$100.00	\$5,600.00	108.63	\$10,863.00	\$5,263.00
20	Pavement Replacement, Aggregate Base	74	TON	\$50.00	\$3,700.00	226.96	\$11,348.00	\$7,648.00
21	Seeding Restoration	70	SY	\$15.00	\$1,050.00	761	\$11,415.00	\$10,365.00
<b>SUM</b>								<b>\$(31,007.03)</b>
*Unit price change rather than quantity.								

Change in Contract Price	Change in Contract Times
Original Contract Price: \$ <u>805,797.76</u>	Original Contract Times: Substantial Completion: <u>December 30, 2025</u> Ready for final payment: <u>January 30, 2026</u>
<b>[Increase] [Decrease]</b> from previously approved Change Orders No. 1 to No. <b>[Number of previous Change Order]</b> : \$ <u>N/A</u>	<b>Increase</b> from previously approved Change Order No.1: Substantial Completion: <u>April 30, 2026</u> Ready for final payment: <u>May 30, 2026</u>
Contract Price prior to this Change Order: \$ <u>805,797.76</u>	Contract Times prior to this Change Order: Substantial Completion: <u>April 30, 2026</u> Ready for final payment: <u>May 30, 2026</u>
<b>Decrease</b> this Change Order: \$ <u>31,007.03</u>	<b>[Increase] [Decrease]</b> this Change Order: Substantial Completion: <u>N/A</u> Ready for final payment: <u>N/A</u>
Contract Price incorporating this Change Order: \$ <u>774,790.73</u>	Contract Times with all approved Change Orders: Substantial Completion: <u>April 30, 2026</u> Ready for final payment: <u>May 30, 2026</u>

Recommended by Engineer

By: *Kau Savelle*

Title: Project Manager

Date: 2026-06-05

Authorized by Contractor

*Michael Snow*

Project Manager

6/9/26

Authorized by Owner

By: \_\_\_\_\_

Title: \_\_\_\_\_

Date: \_\_\_\_\_

## Enabnit, Hannah

---

**From:** Wanner, Paul <pwanner@cityoflawrence.org>  
**Sent:** Wednesday, October 22, 2025 6:44 AM  
**To:** Saavedra, Karen; Gee, Gregory  
**Cc:** Hall, Andrew; Enabnit, Hannah; Newkirk, Eric  
**Subject:** RE: External Sender | FW: Cable Dr Bypass Plan & Proposal - change order for review

You don't often get email from pwanner@cityoflawrence.org. [Learn why this is important](#)

**EXTERNAL EMAIL:** Do not click any links or open any attachments unless you trust the sender and know the content is safe!

Thanks Karen.

Paul Wanner  
Superintendent, Lawrence Utilities  
O: 317-524-6303  
Email: [pwanner@cityoflawrence.org](mailto:pwanner@cityoflawrence.org)  
9201 Harrison Park Court  
Lawrence, IN 46216



CONFIDENTIALITY NOTICE: The information in this e-mail, including any attachment(s), is for the sole use of the intended recipient(s) and may contain confidential and legally privileged information. If you are not the intended recipient, any disclosure, copying, distribution or use of the contents of this information in any manner is strictly prohibited and may be unlawful.

---

**From:** Saavedra, Karen  
**Sent:** Tuesday, October 21, 2025 3:06 PM  
**To:** Wanner, Paul ; Gee, Gregory  
**Cc:** Hall, Andrew ; Enabnit, Hannah ; Newkirk, Eric  
**Subject:** RE: External Sender | FW: Cable Dr Bypass Plan & Proposal - change order for review

**CAUTION:** External Sender

Thanks, Paul, I think this route makes sense. We will work on filling out the change order paperwork. We will not use the terms and conditions that they attached at all – those are from their standard company template. We will just be using the price.

They did say that they have lay flat tube for the bypass that people can drive over as needed.

Karen

**Karen Saavedra, PE**

317-547-5580 [OFFICE](#)

317-995-7120 [CELL](#)

[ksaavedra@structurepoint.com](mailto:ksaavedra@structurepoint.com) [EMAIL](#)

---

**From:** Wanner, Paul <[pwanner@cityoflawrence.org](mailto:pwanner@cityoflawrence.org)>  
**Sent:** Friday, October 17, 2025 9:57 AM  
**To:** Saavedra, Karen <[ksaavedra@structurepoint.com](mailto:ksaavedra@structurepoint.com)>; Gee, Gregory <[ggee@cityoflawrence.org](mailto:ggee@cityoflawrence.org)>  
**Cc:** Hall, Andrew <[ahall@cityoflawrence.org](mailto:ahall@cityoflawrence.org)>; Enabnit, Hannah <[HEnabnit@structurepoint.com](mailto:HEnabnit@structurepoint.com)>;  
Newkirk, Eric <[enewkirk@structurepoint.com](mailto:enewkirk@structurepoint.com)>  
**Subject:** RE: External Sender | FW: Cable Dr Bypass Plan & Proposal - change order for review

**EXTERNAL EMAIL:** Do not click any links or open any attachments unless you trust the sender and know the content is safe!

Karen,

What are the plans for where the bypass hose crosses driveways/road? Would they have some sort of ramps to keep vehicles driving over the hoses?

On the attached map, Greg and I were discussing the route of the by-pass pumping going this way. This would allow the south side of the intersection of Hawks Hill to be closed, and traffic detoured around either direction on Old Orchard Drive. If they have hose ramps, they could use them on the driveways and the street crossing down by 71<sup>st</sup> Street. They could then discharge into MH 10273019 and stay out of the MH in the middle of 71<sup>st</sup> Street.

Also, the “Terms & Conditions” on the attached Proposal need to be revised for this project (in my opinion). The 6<sup>th</sup> bullet point states that this agreement shall comply with Illinois laws.

Greg – if I have overlooked anything we have discussed this morning please chime in.

Paul Wanner  
Superintendent, Lawrence Utilities  
O: 317-524-6303  
Email: [pwanner@cityoflawrence.org](mailto:pwanner@cityoflawrence.org)  
9201 Harrison Park Court  
Lawrence, IN 46216



CONFIDENTIALITY NOTICE: The information in this e-mail, including any attachment(s), is for the sole use of the intended recipient(s) and may contain confidential and legally privileged information. If you are not the intended recipient, any disclosure, copying, distribution or use of the contents of this information in any manner is strictly prohibited and may be unlawful.

---

**From:** Saavedra, Karen <[ksaavedra@structurepoint.com](mailto:ksaavedra@structurepoint.com)>  
**Sent:** Thursday, October 16, 2025 4:20 PM  
**To:** Wanner, Paul <[pwanner@cityoflawrence.org](mailto:pwanner@cityoflawrence.org)>; Gee, Gregory <[ggee@cityoflawrence.org](mailto:ggee@cityoflawrence.org)>  
**Cc:** Hall, Andrew <[ahall@cityoflawrence.org](mailto:ahall@cityoflawrence.org)>; Enabnit, Hannah <[HEnabnit@structurepoint.com](mailto:HEnabnit@structurepoint.com)>;  
Newkirk, Eric <[enewkirk@structurepoint.com](mailto:enewkirk@structurepoint.com)>  
**Subject:** External Sender | FW: Cable Dr Bypass Plan & Proposal - change order for review  
**Importance:** High

**CAUTION: External Sender**

Paul and Greg,

Please see attached change order request from the contractor for \$21,000 to bypass the Cable lift station flow around the couple of sewer lines they need to do CIPP on. Are you ok with this number? If yes, we can prepare the change order. They feel that it is too much flow for them to plug/hold/flow through while they are completing the lining.

Greg, also see their question below about where to discharge the bypass flow, and let us know your opinion. I assume we should tell them to use the manhole in the road.

Thanks,  
Karen

**Karen Saavedra, PE**

317-547-5580 OFFICE

317-995-7120 CELL

[ksaavedra@structurepoint.com](mailto:ksaavedra@structurepoint.com) EMAIL

---

**From:** Michael Snow <[snowmn1687@gmail.com](mailto:snowmn1687@gmail.com)>

**Sent:** Wednesday, October 8, 2025 12:12 PM

**To:** Saavedra, Karen <[ksaavedra@structurepoint.com](mailto:ksaavedra@structurepoint.com)>

**Cc:** Newkirk, Eric <[enewkirk@structurepoint.com](mailto:enewkirk@structurepoint.com)>; Enabnit, Hannah <[HEnabnit@structurepoint.com](mailto:HEnabnit@structurepoint.com)>

**Subject:** Cable Dr Bypass Plan & Proposal

**EXTERNAL EMAIL:** Do not click any links or open any attachments unless you trust the sender and know the content is safe!

Karen,

I apologize for the delay on this pricing but I have attached our bypass plan and proposal below for the found Cable Dr lift station. We are anticipating two weeks total for all phase's needing lift station flow diverted, these two weeks will not be consecutive. 5 consecutive days for the Cable Dr main replacement, 1 day for the two mains to be lined and 5 days for lateral liner installs. We will use a two man operation to maintain the bypass and to ensure pumping is keeping up. During these times we would need the lift station shut down and we will pump directly from the wet well with suction tubes. We have two discharge manhole options as one of the manholes appears to be in a fenced in backyard but was unable to physically see manhole over the fence. The other discharge location is about 300' further but in the road. Please let me know everyone's thoughts and concerns. Once a bypass plan is approved we should be good to move forward with the excavations.

## Legend

- Sanitary Manhole
- Sanitary Sewer Gravity Main
- - - Sanitary Sewer Force Main
- LS** Sanitary Lift Station
- - - Water Main
- Hydrant
- - - Gas Main
- - - Buried AT&T Cable

### Recommended Manhole Rehabilitation

- ◐ Internal Chimney Seal
- ◐ Manhole Lining
- ◐ Manhole Lining, Reset Lid & Frame
- None
- ◐ Reset Lid & Frame, Internal Chimney Seal

### Recommended Sanitary Sewer Rehabilitation

- None
- CIPP, Lateral Lining
- Lateral Lining
- Partial Replacement with Wye, Cut Protruding Tap, CIPP, Lateral Lining
- Full Replacement

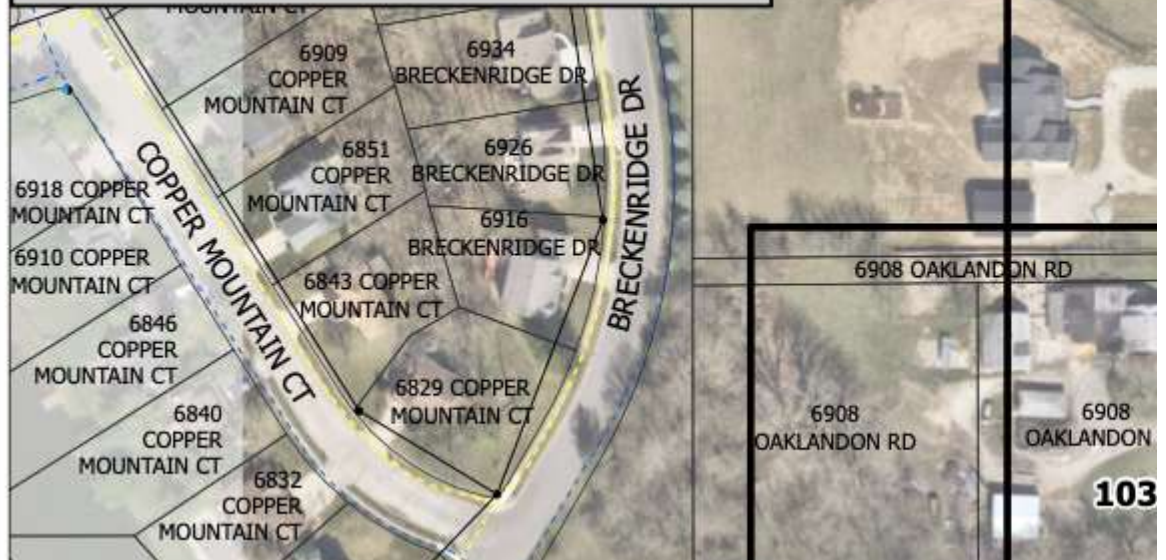

Jser:hnanabonit

Thank you,

**Mike Snow**

***Project Manager***

*Performance Pipelining, Inc.*

1551 W. Norris Drive Ottawa, IL 61350

Office: 815-433-0080

Cell: 630-881-2250

[Snowmn1687@gmail.com](mailto:Snowmn1687@gmail.com)



DISCLAIMER: This message contains confidential information and is intended only for the individual named. If you are not the named addressee, you should not disseminate, distribute, utilize, or copy this e-mail. Please notify the sender immediately by e-mail if you have received this e-mail by mistake, and delete this e-mail from your system. No design changes or decisions made by e-mail shall be considered part of the contract documents unless otherwise specified, and all design changes and/or decisions made by e-mail must be submitted as an RFI or a submittal unless otherwise specified. All designs, plans, specifications and other contract documents (including all electronic files) prepared by the sender shall remain the property of the sender, and the sender retains all rights thereto, including but not limited to copyright, statutory and common-law rights thereto, unless otherwise specified by contract. E-mail transmission cannot be guaranteed to be secure or error-free as information could be intercepted, corrupted, lost, destroyed, arrive late or incomplete, or contain viruses. The sender therefore does not accept liability for any errors or omissions in the contents of this message which arise as a result of e-mail transmission. If verification is required, please request a hard-copy version.

<https://www.structurepoint.com/>



## Enabnit, Hannah

---

**From:** Dubyel, Joe  
**Sent:** Thursday, April 9, 2026 10:57 AM  
**To:** Michael Snow  
**Cc:** Enabnit, Hannah; Saavedra, Karen; Newkirk, Eric  
**Subject:** RE: Lawrence Cable Drive Intermediate Pavement

**Importance:** High

Mike – It looks like your email address was deleted from this when Eric replied.

As Eric stated below, the asphalt item is a unit price item and it is paid at the price per ton that it was bid for the asphalt that is placed.

Please get this work scheduled and completed ASAP and keep us posted so we can keep the City updated. Originally it was stated that this work would be completed at the end of March and it is still not done.

Thank you.

Joe

---

### Joseph A. Dubyel, PE

Field Manager – Central Indiana Construction Solutions

9025 River Road, Suite 200, Indianapolis, Indiana 46240

**CELL** 317-501-8111

**OFFICE** 317-547-5580

**WEB** [www.structurepoint.com](http://www.structurepoint.com)

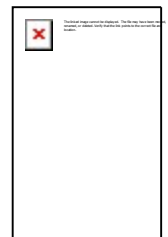

**FULL-SERVICE ARCHITECTURE + ENGINEERING FIRM**

11 DISCIPLINES | 18 DESIGN CENTERS | 7 STATES    

OUR CORE VALUES

RESPECT

RESULTS

DEVELOPMENT

FAMILY

---

**From:** Newkirk, Eric <enewkirk@structurepoint.com>

**Sent:** Wednesday, April 8, 2026 4:51 PM

**To:** Dubyel, Joe <JDubyel@structurepoint.com>

**Cc:** Enabnit, Hannah <HEnabnit@structurepoint.com>; Saavedra, Karen <ksaavedra@structurepoint.com>; Dubyel, Joe <JDubyel@structurepoint.com>

**Subject:** RE: Lawrence Cable Drive Intermediate Pavement

Mike,

Being that this is a unit price item, it is paid at the unit price that was bid and for the quantity that is placed.

Please get this work completed as soon as possible, this has become a big problem.

Thank you,  
Eric

---

**Eric Newkirk, CPESC**

Resident Project Representative

American Structurepoint Inc.

9025 River Road Suite 200

Indianapolis, Indiana 46204

**OFFICE** (317)-547-5580

**CELL** (317)-914-9654

**EMAIL** [enewkirk@structurepoint.com](mailto:enewkirk@structurepoint.com)

**WEB** [www.structurepoint.com](http://www.structurepoint.com)



AMERICAN  
**STRUCTUREPOINT**  
INC.

**FULL-SERVICE ARCHITECTURE + ENGINEERING FIRM**

11 DISCIPLINES | 16 DESIGN CENTERS | 7 STATES

---

**From:** Michael Snow <[snowmn1687@gmail.com](mailto:snowmn1687@gmail.com)>

**Sent:** Wednesday, April 8, 2026 2:56 PM

**To:** Newkirk, Eric <[enewkirk@structurepoint.com](mailto:enewkirk@structurepoint.com)>

**Cc:** Enabnit, Hannah <[HEnabnit@structurepoint.com](mailto:HEnabnit@structurepoint.com)>; Saavedra, Karen <[ksaavedra@structurepoint.com](mailto:ksaavedra@structurepoint.com)>; Dubyel, Joe <[JDubyel@structurepoint.com](mailto:JDubyel@structurepoint.com)>

**Subject:** Re: Lawrence Cable Drive Intermediate Pavement

**EXTERNAL EMAIL:** Do not click any links or open any attachments unless you trust the sender and know the content is safe!

Eric,

Understood. I think the issue is that there are man hours that are associated with the overage of materials that won't be captured by the line item itself. Most of the man hours for the original scope was put into the surface millings. This is why we are asking for a CO to account for this instead of saying there will be an overage on each line item. Hopefully this makes sense but please let me know should you have any other questions.

Thank you,

**Mike Snow**

***Project Manager***

*Performance Pipelining, Inc.*

1551 W. Norris Drive Ottawa, IL 61350

Office: 815-433-0080

Cell: 630-881-2250

[Snowmn1687@gmail.com](mailto:Snowmn1687@gmail.com)

On Apr 8, 2026, at 12:48 PM, Newkirk, Eric <[enewkirk@structurepoint.com](mailto:enewkirk@structurepoint.com)> wrote:

Mike,

That is just an overrun on the original quantity that can be determined once it is all placed, we will also have a overrun on surface as well since the milled area is considerably higher than the bid amount... we will include these overruns in the final change order once all of the tickets are collected.

Please let me know if you have any questions or comments.

Thank you,  
Eric Newkirk  
Structurepoint  
Sent from my iPhone

On Apr 8, 2026, at 12:34 PM, Michael Snow <[snowmn1687@gmail.com](mailto:snowmn1687@gmail.com)> wrote:

You don't often get email from [snowmn1687@gmail.com](mailto:snowmn1687@gmail.com). [Learn why this is important](#)

**EXTERNAL EMAIL:** Do not click any links or open any attachments unless you trust the sender and know the content is safe!

Hannah,

Thank you for the quick response! I have marked up the two maps showing the areas in yellow. This is the original excavation area but with needing to saw cut more of the area around the excavation has the paving contractor under the needed amount to cover all areas. He went from originally needing 54 tons of intermediate to now needing around 70 tons to fill in properly. Pardon my crude maps but hopefully it gives you a better idea of the area.

<Screenshot 2026-04-08 at 11.17.48 AM.png>

<Screenshot 2026-04-08 at 11.25.54 AM.png>

Thank you,

**Mike Snow**

***Project Manager***

*Performance Pipelining, Inc.*

1551 W. Norris Drive Ottawa, IL 61350

Office: 815-433-0080

Cell: 630-881-2250

[Snowmn1687@gmail.com](mailto:Snowmn1687@gmail.com)

<PPI Logo.png>

<PastedGraphic-6.tiff>

On Apr 8, 2026, at 11:12 AM, Enabnit, Hannah

<[HEnabnit@structurepoint.com](mailto:HEnabnit@structurepoint.com)> wrote:

Mike,

Karen is out this week. Can you please provide more information on which areas need pavement that were not accounted for originally? Maybe a markup of the plans would be helpful.

Thank you,  
Hannah

---

**Hannah Enabnit, EI**

Staff Engineer, Utility Infrastructure

9025 River Road, Suite 200, Indianapolis, IN 46240

**OFFICE** 317-547-5580 ex.2625

**WEB** [www.structurepoint.com](http://www.structurepoint.com)

<image004.png>

<image006.png>

<image007.png>

---

**From:** Michael Snow <[snowmn1687@gmail.com](mailto:snowmn1687@gmail.com)>  
**Sent:** Wednesday, April 8, 2026 12:04 PM  
**To:** Saavedra, Karen <[ksaavedra@structurepoint.com](mailto:ksaavedra@structurepoint.com)>  
**Cc:** Newkirk, Eric <[enewkirk@structurepoint.com](mailto:enewkirk@structurepoint.com)>; Enabnit, Hannah <[HEnabnit@structurepoint.com](mailto:HEnabnit@structurepoint.com)>  
**Subject:** Lawrence Cable Drive Intermediate Pavement

**EXTERNAL EMAIL:** Do not click any links or open any attachments unless you trust the sender and you are sure the content is safe!

Karen,

After our paving contractor went on site to see the additional saw cut areas and get needed measurements, it looks as if more asphalt will be needed from what is on the originally bid amount. This requires additional asphalt and additional man hours to complete this work and would require a change order to cover these costs. I am finalizing the schedule between the excavation contractor and the paving contractor to get this work completed right away but want to make sure the City is okay with a change order. Please discuss and let me know, I can get pricing together and submitted as well as our schedule for completing Cable Drive saw cuts and paving.

Thank you,

**Mike Snow**

**Project Manager**

*Performance Pipelining, Inc.*

1551 W. Norris Drive Ottawa, IL 61350

Office: 815-433-0080  
Cell: 630-881-2250  
[Snowmn1687@gmail.com](mailto:Snowmn1687@gmail.com)

<image001.png><image002.png>

DISCLAIMER: This message contains confidential information and is intended only for the individual named. If you are not the named addressee, you should not disseminate, distribute, utilize, or copy this e-mail. Please notify the sender immediately by e-mail if you have received this e-mail by mistake, and delete this e-mail from your system. No design changes or decisions made by e-mail shall be considered part of the contract documents unless otherwise specified, and all design changes and/or decisions made by e-mail must be submitted as an RFI or a submittal unless otherwise specified. All designs, plans, specifications and other contract documents (including all electronic files) prepared by the sender shall remain the property of the sender, and the sender retains all rights thereto, including but not limited to copyright, statutory and common-law rights thereto, unless otherwise specified by contract. E-mail transmission cannot be guaranteed to be secure or error-free as information could be intercepted, corrupted, lost, destroyed, arrive late or incomplete, or contain viruses. The sender therefore does not accept liability for any errors or omissions in the contents of this message which arise as a result of e-mail transmission. If verification is required, please request a hard-copy version. <https://www.structurepoint.com/>

<Screenshot 2026-04-08 at 11.25.54 AM.png><Screenshot 2026-04-08 at 11.17.48 AM.png><PastedGraphic-6.tiff><PPI Logo.png>

## Enabnit, Hannah

---

**From:** Saavedra, Karen  
**Sent:** Thursday, September 18, 2025 5:07 PM  
**To:** 'Michael Snow'  
**Cc:** Newkirk, Eric; Wanner, Paul; Hall, Andrew; Enabnit, Hannah; Max Sucilla; Gee, Gregory  
**Subject:** RE: PPI - Schedule Week of 9/15

Mike,  
Thanks for updates. **See my responses below.**

**Karen Saavedra, PE**  
317-547-5580 OFFICE  
317-995-7120 CELL  
[ksaavedra@structurepoint.com](mailto:ksaavedra@structurepoint.com) EMAIL

---

**From:** Michael Snow  
**Sent:** Wednesday, September 17, 2025 1:11 PM  
**To:** Saavedra, Karen  
**Cc:** Newkirk, Eric ; Wanner, Paul ; Hall, Andrew ; Enabnit, Hannah ; Max Sucilla ; Gee, Gregory  
**Subject:** Re: PPI - Schedule Week of 9/15

**EXTERNAL EMAIL:** Do not click any links or open any attachments unless you trust the sender and know the content is safe!

All,

Please see lateral prep work completed Tuesday 9/16 attached below. My crew did have some findings that will need some questions answered on how to move forward, I have attached those below.

USMH_DSMH	NOTES
10273007_10342066	5 laterals. All PVC NCN
10342066_10342065	6 laterals. All PVC. Located 1 VAT
10342065_10342064	7 Laterals, Cleaned 1 service.
<b>9/16/25</b>	

### Questions:

1.) My crew found manhole 10273007 to be the discharge manhole for a lift station upstream which carries heavy flow. We were unable to time as a city employee was manually pumping this station down. With this amount of flow from a lift station it changes our original standard bypass plan. My estimating team does not remember anything in bid documents mentioning an additional lift station. With the amount of work and planning needed for all work completed downstream of this area, is the City opposed to a change order for bypass in order to bypass this lift station properly? **I will need to discuss**

this with the City, but believe they will be open to this. Can you please prepare a proposal for the bypass system you need so that we can review?

2.) 11920 Cable Dr Lateral ID 10342066-6: Lateral has heavy infiltration pouring in at the connection. We would be unable to line in current condition and would recommend excavating connection or could possibly grout connection to reduce I&I before lateral lining. We also located for a clean out install if grout is used to remove access grout before lateral lining. I have attached a dropbox link to the video below for review. Please advise on how you would like us to proceed. We will add excavating the connection, so increase Bid Item 0011.

Date & Time:	Sep 16, 2025 11:53:00 AM
Surveyed By:	Chad Catlin
Certificate Number:	P0042778-052023
City:	Lawrence
Street:	11925 E 71st St
Lateral Segment Ref:	10342066-6_10342065_391
Upstream MH:	
Downstream MH:	
Weather:	
Direction:	Upstream
Pipe Use:	SS
Material:	Polyvinyl Chloride
Size:	6
Length Surveyed:	27.7
Upstream MH:	
Downstream MH:	
Pipe Segment Reference:	10342066-6_10342065_391
Lateral Segment Reference:	10342066-6_10342065_391

10342066-6\_10342065\_391\_Locate\_U\_20250916\_1153.mp4  
dropbox.com

3.) Some laterals have 4" transitions before the ROW. Without clean outs being installed we would be unable to install transitional liners. Should we line as close to the ROW as safely possible but staying within the 6"? Most transitions seem to be within a couple feet of the ROW, we would line about 3'-4' shy of the transition to allow room for our bladder. Yes, just line as close to R/W as possible staying 6"

Thank you,

**Mike Snow**

**Project Manager**

*Performance Pipelining, Inc.*

1551 W. Norris Drive Ottawa, IL 61350

Office: 815-433-0080

Cell: 630-881-2250

[Snowmn1687@gmail.com](mailto:Snowmn1687@gmail.com)



On Sep 12, 2025, at 1:05 PM, Michael Snow <[snowmn1687@gmail.com](mailto:snowmn1687@gmail.com)> wrote:

All,

I will have a lateral prep crew onsite all next week, they should be onsite early afternoon Monday. They will be starting at the furthest upstream point of Cable Dr and working through the list attached below. Notices were handed out yesterday for the start of this phase and the rest will be handed out throughout the week. I will be onsite Monday and Tuesday to help this crew get started and will have my Superintendent Dan onsite with them all week as well. Please let me know if you have any questions and have a great weekend!

Thank you,

**Mike Snow**

***Project Manager***

*Performance Pipelining, Inc.*

1551 W. Norris Drive Ottawa, IL 61350

Office: 815-433-0080

Cell: 630-881-2250

[Snowmn1687@gmail.com](mailto:snowmn1687@gmail.com)